

Assembly Instructions

ACCU-ARM REMOTE-OPERATED CENTER-OPENING GATE KIT

**FS-PSW501 for Wide Scale (FS-PSW500) or
FS-PSN501 for Narrow Scale (FS-PSN500)**

Tools: Assembly requires the following tools:

- 1/2-in. open end wrench
- 1/2-in. socket and ratchet
- 9/16-in. open end wrench
- 9/16-in. socket and ratchet
- Pliers
- Hammer

Pre-assembly: NOTES: *First and foremost, if the scale has not been previously equipped with crossbars, (① and ②), an ACCU-ARM Basket Top Closure Kit (FS-PSN210 or FS-PSW210) will need to be purchased before assembly of the Remote Gate Kit can be completed. Once the above conditions are met, proceed as instructed. If the scale arm assembly is mounted in the middle of the scale, the basket hanging link pins must be removed from the spade bolts ⑩. If crossbars or a Basket Top Closure Kit has been previously installed, then remove the center long crossbar ① from the scale weigh basket by loosening the center 5/16-in. hex nuts for later. If the scale is assembled with standard side-opening gates, (KS-PSN006 or KS-PSW006), remove them from the gate lock brackets. (Refer to Figure 1 for details.)*

Remote-operated Center-opening Gate Assembly:

1. Locate the two gate control slides ③. Install a gate control slide ③ onto each end of the middle long crossbar ①. Notice that the pins on the gate control slide should be pointed upward and that the longest pin must be positioned closest to the center of the scale. (Refer to Figure 1 and 2 for details.)
2. Install the two gate control rods ④ so that they rest directly upon the scale weigh basket with the handles protruding upward from each end of the scale. Also, be careful that the extended tabs ⑤ on each of the gate control rods ④ are located at opposite ends of the scale and are facing the interior of the scale basket. (Refer to Figure 1 for details.)
3. Install the middle, long crossbar ① with the two assembled gate control slides ③ onto the scale. As this is being done, carefully guide the longest clevis pin, located on each end of the gate control slides ③, through the hole of the extended tabs ⑤ located on the control rods ④. Secure the middle long crossbar with fasteners. Next, if needed install the remaining long crossbar ① and secure with fasteners. Once this is complete, install the short crossbar ② on top of the long crossbars ① and under the basket top ⑨. Secure with fasteners. Now install and tighten the center 5/16 x 7/8-in. bolt, two 3/8-in. spade bolts, lockwashers, and hex nuts that fasten the center long crossbar ① to the short crossbar ②. (Refer to Figure 1 for details.)
4. Attach each of the four gate links ⑤ to the gate control slides ③ by slipping the small hole in each gate link ⑤ over one of the mating pins located on each of the gate control slides ③. Notice that the gate control rods ④ may now lie on top of the gate links ⑤. (Refer to Figure 1, 2, and 3 for details.)
5. Now, place the gate rod control guides ⑥ over the gate control rods ④ and the gate control slide ③. Be careful that the longest clevis pin on each gate control slide ③ is inserted into the small hole of the gate rod control guide ⑥. (Refer to Figure 1 and 2 for details.)
6. Fasten the gate rod control guides ⑥ to the longest clevis pin on each gate control slide ③ with 1-each 1/4-in. flat washer ⑦a, spring ⑦b, 1/4-in. flat washer ⑦c, and a 3/32 x 3/4-in. cotter pin ⑦c combination. (Refer to Figure 1 and 2 for details.)
7. Install the four gate drop rods ⑩ into the side tubes of the remote-operated center-opening gates ⑧. Insert the gate into the gate lock brackets located on each end of the basket top ⑨. Place the 1-in. end hole on each gate link ⑤ onto the center extension tube of each center open gate ⑧. Place the vinyl handle caps ⑦d on each end of the gate control rod handles ④. (Refer to Figure 1 and 3 for details.)
8. Installation is now complete. Open the gates by lifting the control rods upward while pushing (or pulling) the control rods. Close the gates by either pushing the gates closed or pushing/pulling on the control rods. The gates should open and close easily and should also lock automatically so the gates can not be opened unless the control rod is lifted.

REMOTE GATE KIT REFERENCE LIST:

Item No.	Qty.	Part No.	Description
1 +	2	KS-PS0014	Long crossbar
2 +	1	SS-PSW005	Short crossbar, wide scale
or	1	SS-PSN005	Short crossbar, narrow scale
3 *	2	KS-PS0102	Gate control slide
4 *	2	KS-PS0101	Remote gate control rod handle
5 *	4	KS-PSW102	Remote gate link, wide scale
or	4	KS-PSN102	Remote gate link, narrow scale
6 *	2	KS-PS0103	Gate rod control guide
7 *	1	KS-PS0105	Remote gate fastener kit
7a	4	RFW-1100	1/4-in. Flat washers, zinc plated
7b	2	RFM-4300	Spring
7c	2	RFM-3217	3/32 x 3/4-in. Cotter pin
7d	4	RFP-6101	Vinyl handle caps
8	4	KS-PSW101	Center-open gate, wide scale
or	4	KS-PSN101	Center-open gate, narrow scale
9	1	KS-PSW002	Basket top, wide scale
or	1	KS-PSN002	Basket top, narrow scale
10	4	KS-PS0007	Gate drop rod
11	2	RFB-3065	3/8 x 7/8-in. Spade bolt, zinc plated
c	-	-	Gate control rod extended tabs

* Parts included in Remote Gate Kit.

* Parts included with the Top Closure Kit.

All other parts were shipped with scale.

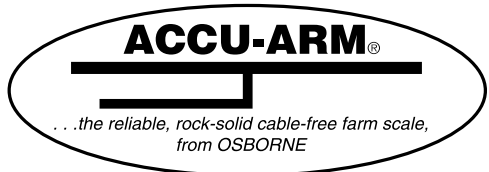

Figure 2

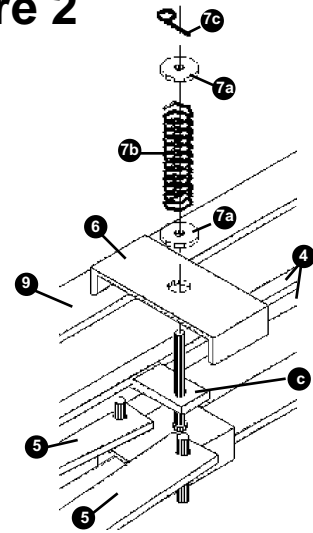

Figure 1

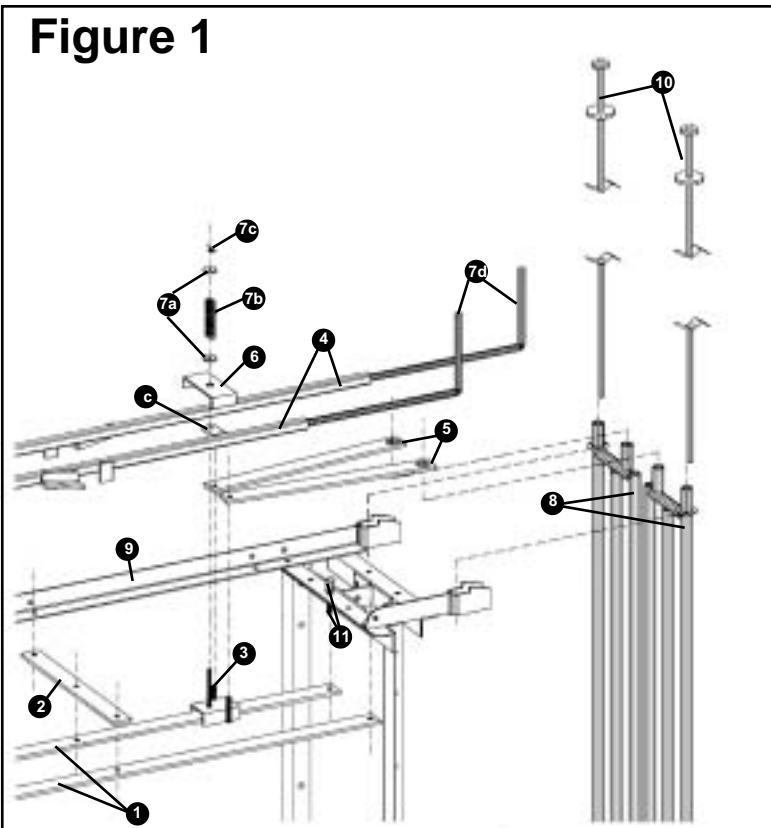

Figure 3

